

Courtesy Of Darin B Baxandall Of RE/MAX Elite

\$559,000 - 34 Foxboro Close, Sherwood Park

MLS® #E4459616

\$559,000

3 Bedroom, 3.00 Bathroom, 1,419 sqft

Single Family on 0.00 Acres

Foxboro, Sherwood Park, AB

STUNNING, GORGEOUS, METICULATE + COMPLETELY RENOVATED 4 LEVEL SPLIT!

This perfect family friendly home in Foxboro is **PERFECTION** for you and your family! From top to bottom this home will impress you!

Greeting you is a cozy front room leading you to the most spectacular kitchen with S/S appliances, giant quartz island and an abundance of custom, white cabinets. Perfect dining area overlooking patio doors to large, treed + private backyard. Upstairs boasts a master bedroom w/ 3pce ensuite & a large custom closet + 1 other kids sized bedrooms & 4pce bathroom. Lovely glass panel to lower living space w/perfect sized family room and exquisite stone floor to ceiling fireplace + one more childrens bedroom & 4pce bathroom. Finished basement completes this home with large laundry area + additional rec room/workout room space. There's so many extras to enjoy! This home will check off all the boxes! If you're looking for a dream home in Foxboro look no further!

Built in 2000

Essential Information

MLS® # E4459616

Price \$559,000

Bedrooms 3

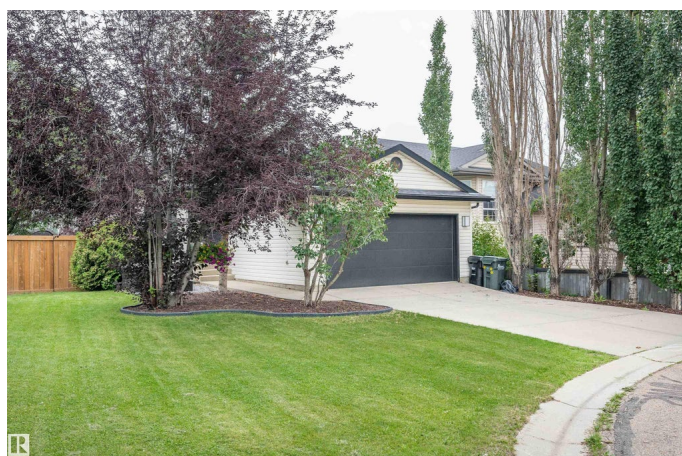
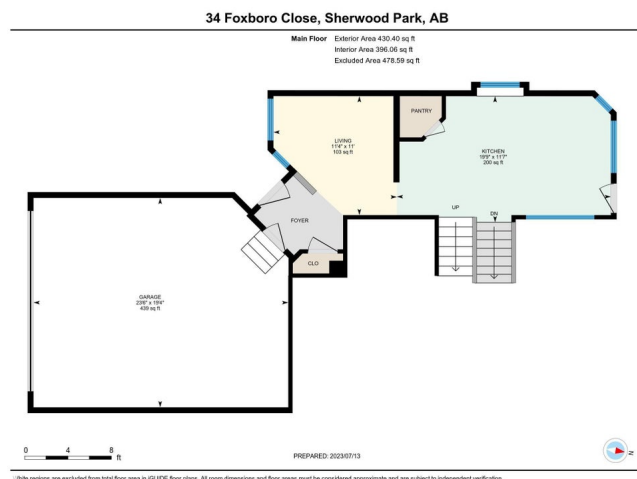

Bathrooms	3.00
Full Baths	3
Square Footage	1,419
Acres	0.00
Year Built	2000
Type	Single Family
Sub-Type	Detached Single Family
Style	4 Level Split
Status	Active

Community Information

Address	34 Foxboro Close
Area	Sherwood Park
Subdivision	Foxboro
City	Sherwood Park
County	ALBERTA
Province	AB
Postal Code	T8A 6C1

Amenities

Amenities	Exercise Room, No Smoking Home
Parking	Double Garage Attached

Interior

Interior Features	ensuite bathroom
Appliances	Dishwasher-Built-In, Dryer, Refrigerator, Stove-Electric, Washer, Window Coverings
Heating	Forced Air-1, Natural Gas
Stories	4
Has Basement	Yes
Basement	Full, Finished

Exterior

Exterior	Wood, Vinyl
Exterior Features	Cul-De-Sac, Fenced, Fruit Trees/Shrubs, Landscaped, Playground Nearby, Schools, Shopping Nearby, Treed Lot, See Remarks
Roof	Asphalt Shingles
Construction	Wood, Vinyl
Foundation	Concrete Perimeter

School Information

Middle FR Haythorne
High Bev Facey

Additional Information

Date Listed September 26th, 2025
Days on Market 3
Zoning Zone 25

DATA IS DEEMED RELIABLE BUT IS NOT GUARANTEED ACCURATE BY THE REALTORS® ASSOCIATION OF EDMONTON. COPYRIGHT 2025 BY THE REALTORS® ASSOCIATION OF EDMONTON. ALL RIGHTS RESERVED.Trademarks are owned or controlled by the Canadian Real Estate Association (CREA) and identify real estate professionals who are members of CREA (REALTOR®, REALTORS®) and/or the quality of services they provide (MLS®, Multiple Listing Service®)
Listing information last updated on September 29th, 2025 at 12:47pm MDT